



Housing Morphology in Clerkenwell

Langdon House

Fieldwork & Analysis carried out by Farhad Mortezaee and Huali Zhang



Ground Floor Use



First Floor Use

Background

Discussion

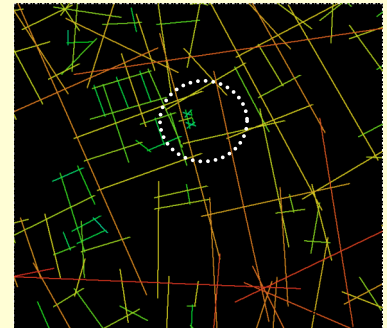

Variable	Value
Number of axial lines	4725
Mean Global Integration (Radius n)	1.2577
Mean Local Integration (Radius 3)	2.6318
Mean Depth from Most Integrated	7
Mean Integration (Radius=Radius)	1.7328
No. of Cul-de-sacs (connectivity=1)	222



Insert Doors & Entrances



Primary & Secondary Boundaries Only



Land Area Distribution Map

Variable	Value
[EHCS] Housing unit Type	Social
Purpose built/converted	Purpose built
Year of original building	1993
Year of conversion	
[EHCS] age band	
Total site area	5246
No. of stories	12
Total area of building foot print	750
no. of car parking spaces	0
no. of dwelling entrances	1
no. of non-residential entrances	2

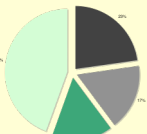
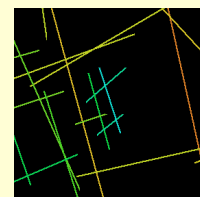

- Active frontage
- Door & windows
- Doors only
- Windows only
- Upper visibility
- Blank Wall
- High Opaque Fence
- High See through fence
- low fence
- Very Low fence
- Road
- Path
- Vertical access
- Car park
- Common green/leisure
- Private garden/yard
- Restricted access
- Building
- Other

Discussion

Variable	Value
No. of internal axial lines	6
No. of convex spaces	6
Ratio of axial lines/convex spaces	0.833333333
Mean Global Axial Integration	
Mean Global Convex Integration	
Maze index	
Non-neighbours score	
Separation index	
Constitutedness rate	
Neighbouriness score	

Flat Types

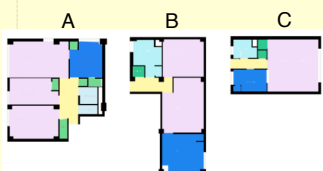

Discussion

Housing type	no. of convex spaces	no. of transition spaces	Mean Global Integration	Mean Depth from Threshold	No. of entrances
Type A	7				
Type B	8				
Type C	4				

Housing type	Habitable Area	Kitchen Area	Bathing Area	Circulation Area	Storage Area
Type A	52	12.65	5.5	8.29	2
Type B	40.55	15	8	5.1	2
Type C	28.76	7.6	4.29	3.19	2

Discussion

Housing Unit	No. of Units	Total Area	No. of Living Spaces	No. of Bedrooms	No. of Bedspaces
Type A	22	80.44	3	2	2
Type B	11	70.65	2	1	1
Type C	6	43.84	1	0	1
Totals	39	196.93	6	3	4